



# Nickel Plated Brass Compact Fittings ISO Thread

## Construction

- Nickel plated brass fitting, has a four piece construction consisting of a gland nut, sealing ring, high tensile grounding ferrule and body.
- Includes sealing ring.
- Excellent corrosion resistance, strength and durability.



**Straight** - ISO Thread 3/8" through 2"

**90°** - ISO Thread 3/8" through 2"

## Installation

- Fitting is ideal for use with standard liquid-tight conduit to allow easy installation. IP 66/67 Rated when installed with approved conduit.
- Approved for both exposed and concealed locations. Rated for temperature ranges -49°F to + 221°F (-45°C to +105°C).
- Suitable for harsh industrial, food and beverage, petrochemical, waste water, salt water and other corrosive applications.
- Suitable for use in hazardous locations per NEC Articles 501 Class I Div. 2, Article 502 Class II Div. 1 & 2, Article 503 Class III Div. 1 & 2.
- Compact design is ideal for tight spaces.
- Complies with UL Standard 514B File No. E234207.

## NEC Articles

- Article 501.10 (B) (2) Class I Div. 2
- Article 502.10 (A) (2) and (B) (2) Class II Div. 1 & 2
- Article 503.10 (A) (3) and (B) Class III Div. 1 & 2

[www.ul.com](http://www.ul.com)

[www.nfpa.org](http://www.nfpa.org)

[www.nema.org](http://www.nema.org)

[www.csa-international.org](http://www.csa-international.org)

[www.naed.org](http://www.naed.org)

[www.anametelectrical.com](http://www.anametelectrical.com)



• RoHS WEEE COMPLIANT

## ISO Straight Compact Fittings

Size mm	Sealtite Size (inch)	Min. Internal Bore (mm)	Dimensions in inches					Standard Package	PIN Number	Weight (lbs/100)
			A	B	C	D	E			
M16 X 1.5	3/8"	10.4	1.181	0.393	1.023	-	0.944	10	7120161	9.3
M20 X 1.5	3/8"	10.4	1.181	0.393	1.023	-	0.944	10	7120171	9.7
M20 X 1.5	1/2"	13.8	1.260	0.393	1.141	-	1.063	10	7120201	11.0
M25 X 1.5	3/4"	18.5	1.299	0.393	1.378	-	1.299	10	7120251	16.3
M32 X 1.5	1"	23.8	1.417	0.472	1.771	-	1.732	5	7120321	30.6
M40 X 1.5	1-1/4"	31.9	1.574	0.511	2.086	-	1.968	2	7120401	41.4
M50 X 1.5	1-1/2"	36.9	1.811	0.551	2.441	-	2.283	2	7120501	63.9
M63 X 1.5	2"	47.9	2.047	0.630	2.992	-	2.834	2	7120631	95.7

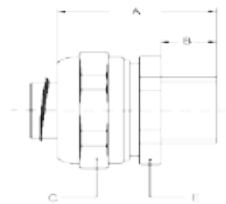

## ISO 90° Compact Fittings

Size mm	Sealtite Size (inch)	Min. Internal Bore (mm)	Dimensions in inches					Standard Package	PIN Number	Weight (lbs/100)
			A	B	C	D	E			
M16 X 1.5	3/8"	10.4	1.023	0.393	1.023	1.220	0.866	10	7129161	15.4
M20 X 1.5	3/8"	10.4	1.023	0.393	1.023	1.260	0.944	10	7129171	15.9
M20 X 1.5	1/2"	13.8	1.110	0.393	1.141	1.338	1.063	10	7129201	18.5
M25 X 1.5	3/4"	18.5	1.260	0.393	1.378	1.574	1.299	10	7129251	38.6
M32 X 1.5	1"	23.8	1.574	0.472	1.771	1.929	1.653	5	7129321	64.8
M40 X 1.5	1-1/4"	31.9	1.811	0.511	2.086	1.968	2.047	2	7129401	91.7
M50 X 1.5	1-1/2"	36.9	2.204	0.551	2.441	2.244	2.362	2	7129501	129.2
M63 X 1.5	2"	47.9	2.441	0.630	2.992	2.677	2.834	2	7129631	209.0

